

# INDUSTRIAL SPACE FOR LEASE

## 21,346 s.f. Available Immediately



**170 Alden Road, Unit 1**  
**Markham, Ontario**

**EMERY**  
INVESTMENTS  
**Mary Wood**  
&  
**Elana Quinn**  
**416-630-6927**

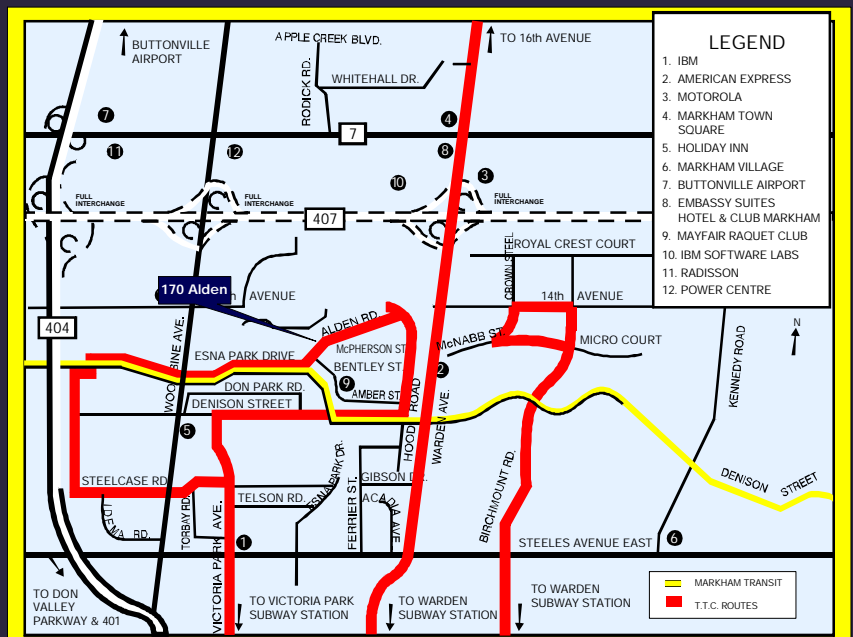

# INDUSTRIAL SPACE FOR LEASE

## 21,346 s.f. Available Immediately

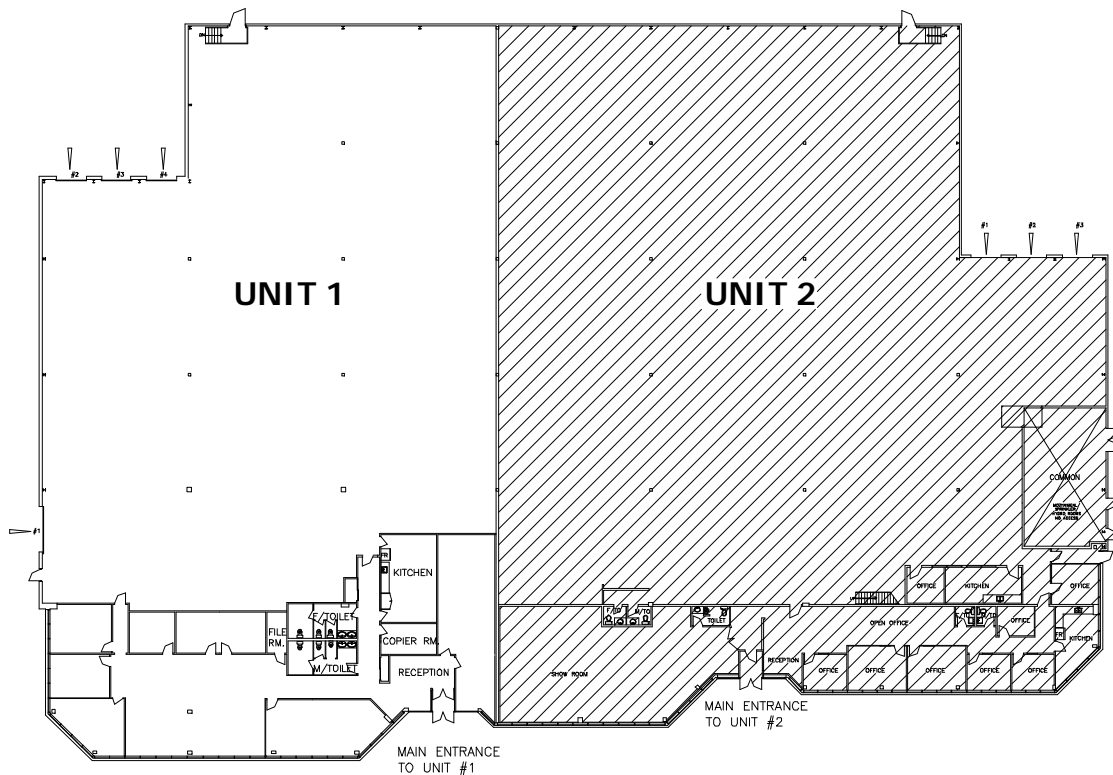

### PROPERTY DETAILS

**Occupancy:**  
Immediate

**Space Available:**  
21,346 s.f.

**Office:**  
4,820 s.f.

**Parking:** 50 spaces

**Height:** 22' clear

**Bay Size:** 30' x 40'

**Hydro:**  
200 amps/600 volts  
Upgradable to 1000 amps/600 volts

**Shipping:**  
3 Truck-level, 1 Drive-in

**Access:**  
Excellent access to major Hwys.  
407, 401, 404 & DVP.

**Public Transportation:**  
TTC on Woodbine connecting  
to Victoria Park Subway Station.

# EMERY

INVESTMENTS

**For Leasing Information:**  
Mary Wood & Elana Quinn  
Telephone: 416-630-6927  
E-mail: [info@emeryinvestments.com](mailto:info@emeryinvestments.com)  
Web-Site: [www.emeryinvestments.com](http://www.emeryinvestments.com)

620 Wilson Avenue Suite 401, Toronto, Ontario M3K 1Z3 Tel: 416-630-6927 Fax: 416-630-6997