

INDUSTRIAL SPACE FOR LEASE

14,400 s.f. Immediate Occupancy



7615 Kimbel St., Units 3 - 5
Mississauga, Ontario

EMERY

INVESTMENTS

Mary Wood
&
Elana Quinn
416-630-6927

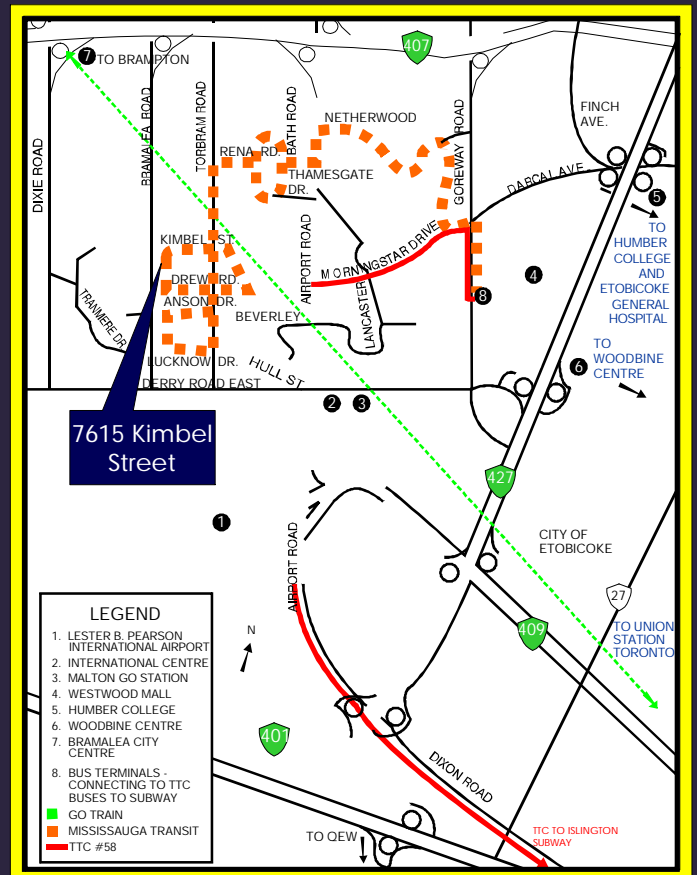

INDUSTRIAL SPACE FOR LEASE

14,400 s.f. Immediate Occupancy

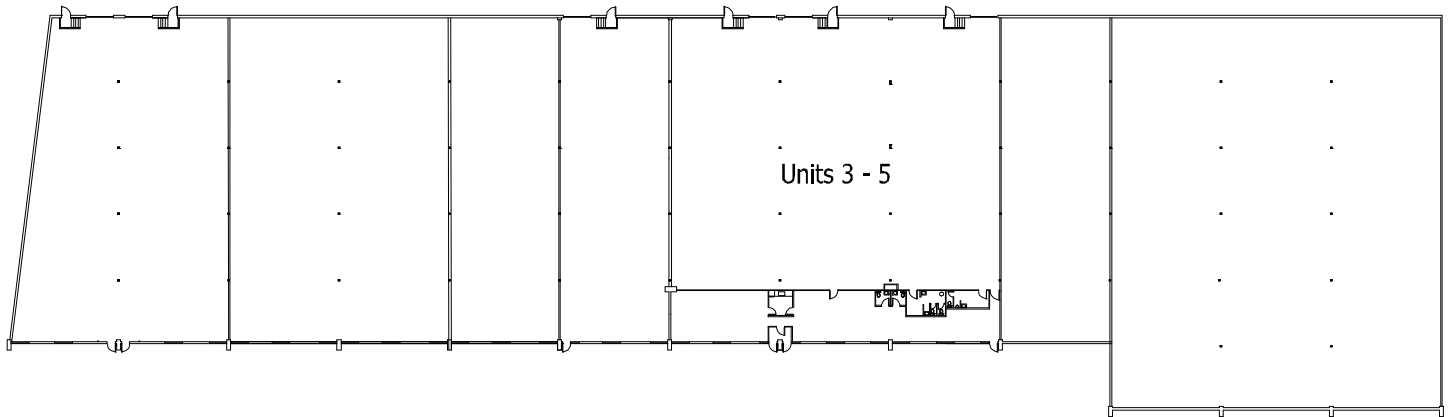

PROPERTY DETAILS

Occupancy: Immediate

Shipping: 3 Truck Level

Space Available: 14,400 s.f.

Bay Size: 30' x 40'

Office Space: 2,267 s.f.

Access: Easy access to 401 & 407
via Airport Rd.

Height: 16' clear

Public Transportation:

Hydro: 200 amps/600 volts

Rush hour service to Islington Subway
Station. Regular service on Derry Rd.

EMERY
INVESTMENTS

For Leasing Information:

Mary Wood & Elana Quinn

Telephone: 416-630-6927

E-mail: info@emeryinvestments.com

Web-Site: www.emeryinvestments.com