

INDUSTRIAL SPACE FOR LEASE

12,135 s.f. Immediate Occupancy



450 Tapscott Road, Unit 3
Scarborough, Ontario

EMERY

INVESTMENTS

Mary Wood
&

Elana Quinn
416-630-6927

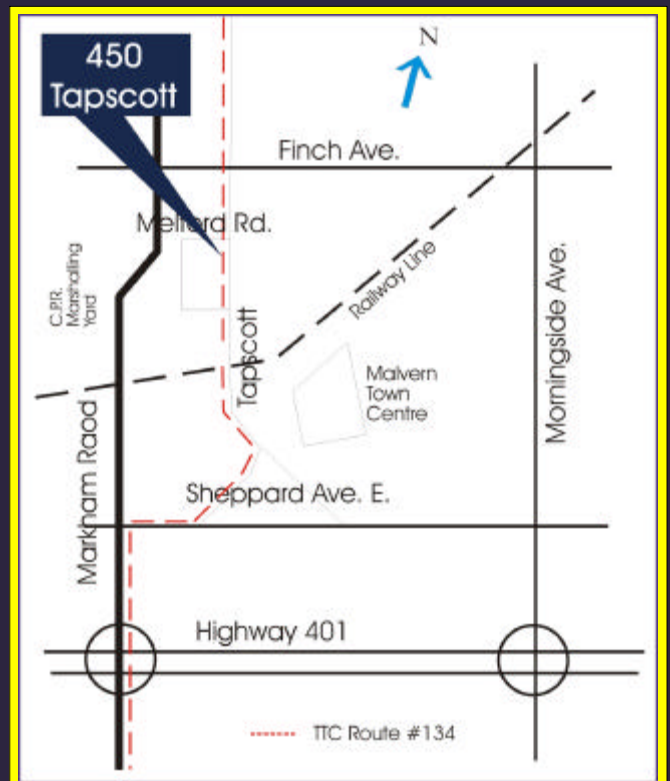

INDUSTRIAL SPACE FOR LEASE

12,135 s.f. Immediate Occupancy

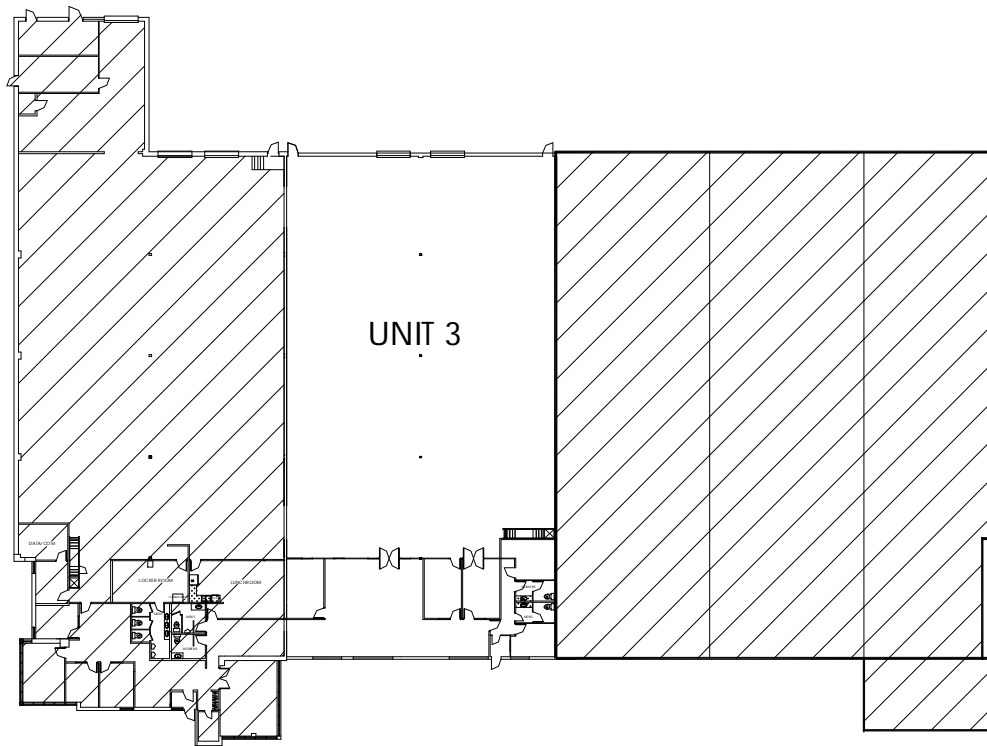

PROPERTY DETAILS

Occupancy: Immediate

Height: 16' clear

Space Available:
12,135 s.f.

Bay Size: 40' x 30'

Office Space:
2,235 s.f.

Access:
Easy access to Hwy. 401 and Hwy. 407 via Markham Road.

Hydro:
200 amps/600 volts

Public Transportation:
TTC on Tapscott connecting to Scarborough Town Centre Subway and GO Station.

Shipping:
2 Truck-level

EMERY
INVESTMENTS

For Leasing Information:
Mary Wood & Elana Quinn

Telephone: 416-630-6927

E-mail: info@emeryinvestments.com

Web-Site: www.emeryinvestments.com

620 Wilson Avenue Suite 401, Toronto, Ontario M3K 1Z3 Tel: 416-630-6927 Fax: 416-630-6997